

This instruction manual contains IMPORTANT WARNINGS, CAUTIONS and INSTRUCTIONS. Equipment in this instruction manual is exclusively for coating purposes. Do not use for other purposes.
 The operator shall fully understand the requirements stated within the instruction manual including important warnings, cautions and operation and correct handling.
 Read and understand the instruction manual before use and retain for reference.

INSTRUCTION MANUAL

Aqua Dry Gun ADG-1

Incorrect operation or mishandling can cause serious bodily injury, death, fire, explosion, finish problem and spray gun malfunction. Pay special attention to section shown with the symbols below.
 The safety precautions in this instruction manual describe the minimum necessary information. Be sure to follow national and local regulations on fire prevention, electricity and safety as well as your own corporate regulations.

- WARNING** This symbol indicates that a potentially hazardous situation may result in serious injury or death if not followed.
- CAUTION** This symbol indicates that a potentially hazardous situation may result in minor or moderate injury or damage.

Important Specifications

Max. Air Pressure	0.68MPa / 6.8bar / 98psi	Operating Air Temperature	5 - 43°C (41 - 110°F)
Noise Level	78 dB(A)		

Main Specifications

Model	Standard Inlet Air Pressure MPa (bar/psi)	Air Consumption L/min (cfm)	Remarks
ADG-1	0.1 (1.0/14)	390 (13.8)	

Safety Warnings

WARNING

1. Be sure to tighten all connection, If not, it can cause problem and injury.
2. Be sure to use spray gun at less than the maximum working pressure.
3. Wear hearing protection. Noise level can exceed more than 78dB(A) depending on use and working conditions.
4. Wear eye protection.
5. Never use near/toward a person or animals. High air pressure can cause serious injury.
6. Use only with pressured air. Never use any other gas. It can cause difficult breathing, serious bodily injury, fire and explosion.
7. If operation appears incorrect, immediately stop operation and find the cause. Never use until the problem has been solved.
8. Repair or replace worn or damaged parts immediately. Always use ANEST IWATA replacement parts.



CAUTION

1. Put pressured air through and blow air toward a rug before using when first time use after purchasing. Anti-corrosive oil is applied inside gun. If not, it can cause finish problem.
2. Use clean air filtered through a dryer and a filter finer. If not, it can cause finish problem.



Maintenance and inspection

CAUTION

1. Always release air pressure before cleaning, disassembly or service.
2. Never soak whole gun into solvent for cleaning. It can cause gun malfunction.
3. Never disassemble spray gun without receiving proper education and training.

Parts list

No.	Description	Qty
1	Nozzle	1
2	Lock Nut	1
3	Gun Body Set	1
4	Filter	1
5	Filter Cover	1

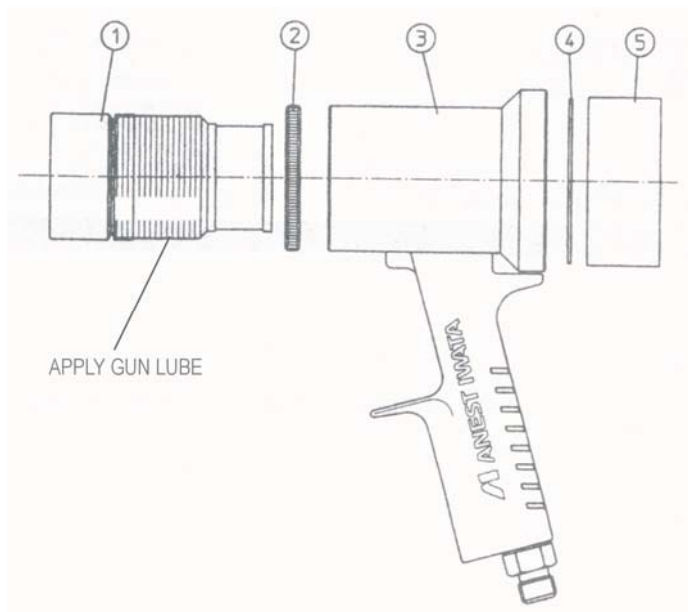

How to operate

1. Connect air hose on Air Inlet.
2. Set inlet air pressure 0.1MPa (1.0bar/14psi) - 0.68 MPa (6.8bar/98psi).
3. Tighten Nozzle to full close position.
4. Loosen the Nozzle and adjust airflow. Loosening Nozzle approximately 40 degrees from full close position will achieve max airflow.
5. Adjust inlet air pressure if necessary.
6. Hand tighten Lock Nut to secure Nozzle.

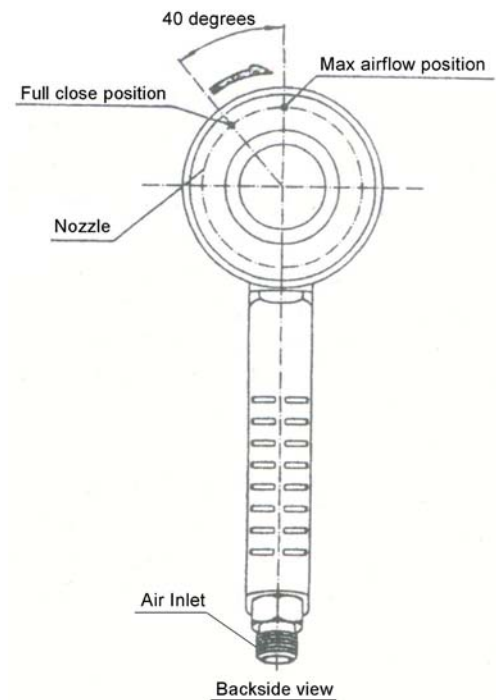

ANEST IWATA Corporation

3176 Shin yoshida-cho, Kohoku-ku, Yokohama 223-8501, Japan

Code No. 03451470
No. 1400